

KNZ®

GoDuo Buds True Wireless Dual-driver Earbuds With Charging Case

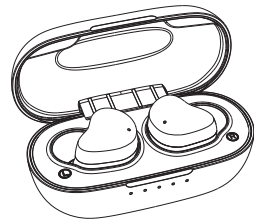

User Manual

What is in the box

- Earbud x 1 pair
- Wireless charging case x 1
- USB-C charging cable x 1
- Soft ear tips x 3 pairs (medium pair installed on earphones)
- User manual x 1

Specification

- Pairing name (device ID): GoDuo Buds
- Wireless version: 5.0
- Charging port: USB type-C
- Charging time: 2 hours (USB-C), 4 hours (wireless)
- USB input: 5V/1A Max.
- Wireless charging input: 5W Max.
- Earphone weight: 5.2g (0.18 oz)
- Total weight: 44.5g (1.57 oz)
- Music playing time: up to 7 hours (earphone only); up to 30 hours (with charging case)
- Range: 10m (33 ft)
- Frequency response range: 20Hz - 20kHz

Product Overview

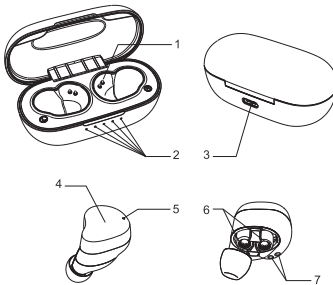

- 1. Charging pins on the case
- 2. Charging case LED light
- 3. USB type-C charging port
- 4. Multi-function touch control
- 5. Earbud LED light/Microphone
- 6. Dual speaker drivers
- 7. Charging pins on the earbud

Quick Reference Guide

Charge Earphone	Put the earphone into the charging case, making sure the charging pins on earphones are in good contact with the charging pins on the case
Charging Case LED Light Status	Solid white light means earphones are being charged Solid red light and flashing white light mean the case is being charged via USB type-C or wireless charger
Earphone Pairing Mode	Blue light and red light flash alternately on one earphone, and blue light flashes every 4 seconds on the other earphone
Power On/Off	The earphones automatically power on when taken out from the charging case, and power off when put back into the charging case
Answer/End Call	One short touch on the left or right earphone (All touch operations needs to be on the "multi-function touch control" area on the earphone)
Reject Call	Long touch for 2 seconds on either earphone
Music Play/Pause	One short touch on the left or right earphone
Last Song	Double tap on the left earphone
Next Song	Double tap on the right earphone
Volume Down	Long touch for 2 seconds on the left earphone
Volume Up	Long touch for 2 seconds on the right earphone

Siri	Triple-tap on either earphone to activate Siri
Charge Case	Connect the case to USB power adaptor via the USB type-C cable, or put the case on any Qi wireless charging pad to start charging

Pairing GoDuo Buds for the First Time

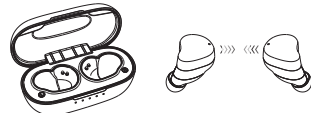

- Take GoDuo Buds earbuds out of the charging case, and the earphones will power on automatically. Put the left and right earphones close to each other (within 2 inches), and they will pair with each other. The LED light on one earphone will flash in red and blue alternately, and the LED light on the other earphone flashes in blue every 4 seconds.
- Enable Bluetooth on your mobile device, discover and find the device named "GoDuo Buds". Choose to connect with it. After successful connection, the LED light on earphone will flash slowly in blue. Now GoDuo Buds earbuds are ready to use.

Note: If the GoDuo Buds earbuds are not connected to any devices, they will automatically power off after 5 minutes.

Use Single Earbud

Follow the above steps to connect GoDuo Buds earbuds with your mobile device. After successful connection, put either earbuds back into the charging case, and the other earbuds will stay working.

Wearing

Place the earbuds into ear canal. Gently turn it until it securely sits in the ear. Wearing wrongly may affect signal reception or microphone quality.

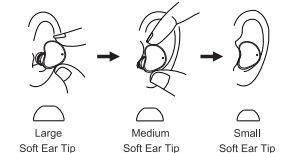

There are total 3 sizes of ear tips (medium size installed on the earbuds). Choose the best fit for optimal listening experience.

Attention

- Before you use the product please read the manual carefully and keep it for reference.
- Do not disassemble the product by yourself.
- Keep the product away from heat sources.
- Do not place the product in humid climates.
- Keep water or other liquid away from the product.
- Please avoid dropping.
- Keep the product away from chemical solvent.
- Charge this product with DC 5V charger only.
- Fully charge before you use the headphones for the first time.
- Product contains batteries and must be disposed properly. Do not try to replace the built-in batteries by yourself.

FCC Statement

This equipment has been tested and found to comply with the limits for a Class B digital device, pursuant to part 15 of the FCC Rules.

These limits are designed to provide reasonable protection against harmful interference in a residential installation. This equipment generates, uses and can radiate radio frequency energy and, if not installed and used in accordance with the instructions, may cause harmful interference to radio communications. However, there is no guarantee that interference will not occur in a particular installation.

If this equipment does cause harmful interference to radio or television reception, which can be determined by turning the equipment off and on, the user is encouraged to try to correct the interference by one or more of the following measures: (1)Reorient or relocate the receiving antenna. Increase the separation between the equipment and receiver. (2)Connect the equipment into an outlet on a circuit different from that to which the receiver is connected. (3)Consult the dealer or an experienced radio/TV technician for help.

This device complies with part 15 of the FCC Rules. Operation is subject to the following two conditions: (1)This device may not cause harmful interference, and (2)This device must accept any interference received, including interference that may cause undesired operation.

Changes or modifications not expressly approved by the party responsible for compliance could void the user's authority to operate the equipment.

For further inquiries:
www.knztch.com/support

Warranty & Return Policy

KNZ Technology, LLC, warrants this product as free of defects in material, design, and workmanship for the period of one year from the original date of purchase. The warranty is limited to the original purchaser. If during the period of warranty this product proves defective under normal use and service, you should return the product to the retailer from whom it was purchased or to an authorized warranty center.

The liability of KNZ Technology, LLC, and its appointed repair company is limited to the cost of repair and/or replacement of the product under warranty. Products sent for warranty service must be accompanied by a copy of the original purchase receipt, the original box, materials, and accessories. All cost associated with the return of the product under warranty are the responsibility of the original purchaser. Shipping and Handling Fee will apply in order for KNZ Technology, LLC, to ship out a new or refurbished product to a customer. KNZ Technology, LLC, will not assume any responsibility for any loss or damage occurred in shipping.

KNZ is registered trademark of KNZ Technology, LLC. All other trademarks are the property of their respective owners. Copyright 2021. All rights reserved. This product is not a toy. Contains small parts, not for children under 3 years.